

Medium Voltage Current Transformer

CTWH3-60-T100

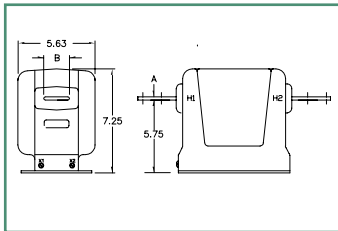
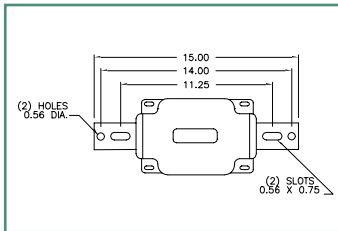

| Part Number* | Current Ratio | Relay Class | ANSI Metering Class at 60 Hz | | | | | **Thermal Current Rating 1 second RMS Amps |
|-------------------|---------------|-------------|------------------------------|------|------|------|------|--|
| | | | B0.1 | B0.2 | B0.5 | B0.9 | B1.8 | |
| CTWH3-60-T100-050 | 5:5 | T100 | 0.3 | 0.3 | 0.3 | 0.3 | 0.3 | 470 |
| CTWH3-60-T100-100 | * 10:5 | T100 | 0.3 | 0.3 | 0.3 | 0.3 | 0.3 | 900 |
| CTWH3-60-T100-150 | * 15:5 | T100 | 0.3 | 0.3 | 0.3 | 0.3 | 0.3 | 1600 |
| CTWH3-60-T100-200 | * 20:5 | T100 | 0.3 | 0.3 | 0.3 | 0.3 | 0.3 | 1900 |
| CTWH3-60-T100-250 | * 25:5 | T100 | 0.3 | 0.3 | 0.3 | 0.3 | 0.3 | 2600 |
| CTWH3-60-T100-300 | * 30:5 | T100 | 0.3 | 0.3 | 0.3 | 0.3 | 0.3 | 2900 |
| CTWH3-60-T100-400 | * 40:5 | T100 | 0.3 | 0.3 | 0.3 | 0.3 | 0.3 | 3800 |
| CTWH3-60-T100-500 | * 50:5 | T100 | 0.3 | 0.3 | 0.3 | 0.3 | 0.3 | 4700 |
| CTWH3-60-T100-750 | * 75:5 | T100 | 0.3 | 0.3 | 0.3 | 0.3 | 0.3 | 5900 |
| CTWH3-60-T100-101 | * 100:5 | T100 | 0.3 | 0.3 | 0.3 | 0.3 | 0.3 | 8600 |
| CTWH3-60-T100-151 | * 150:5 | T100 | 0.3 | 0.3 | 0.3 | 0.3 | 0.3 | 12900 |
| CTWH3-60-T100-201 | * 200:5 | T100 | 0.3 | 0.3 | 0.3 | 0.3 | 0.3 | 17200 |
| CTWH3-60-T100-251 | * 250:5 | T100 | 0.3 | 0.3 | 0.3 | 0.3 | 0.3 | 17200 |
| CTWH3-60-T100-301 | * 300:5 | T100 | 0.3 | 0.3 | 0.3 | 0.3 | 0.3 | 34500 |
| CTWH3-60-T100-401 | * 400:5 | T100 | 0.3 | 0.3 | 0.3 | 0.3 | 0.3 | 34500 |
| CTWH3-60-T100-601 | * 600:5 | T100 | 0.3 | 0.3 | 0.3 | 0.3 | 0.3 | 66200 |
| CTWH3-60-T100-801 | * 800:5 | T100 | 0.3 | 0.3 | 0.3 | 0.3 | 0.3 | 66200 |
| CTWH3-60-T100-102 | * 1000:5 | T100 | 0.3 | 0.3 | 0.3 | 0.3 | 0.3 | 66200 |
| CTWH3-60-T100-122 | * 1200:5 | T100 | 0.3 | 0.3 | 0.3 | 0.3 | 0.3 | 66200 |

** With a burden of B 0.1 or greater connected to the secondary.

Applications

Metering and relaying.

Frequency

50 - 400 Hz.

Maximum System Voltage

5.6kV, BIL 60kV full wave.

Continuous Thermal Current Rating Factor

1.50 at 30° C amb., 1.33 at 55° C amb.

250:5, 1000:5 & 1200:5

1.10 at 30° C amb., 0.85 at 55° C amb.

Primary Terminals

Plated copper bars. See chart for sizes.

Secondary Terminals

Brass screws No. 10-32 with one flatwasher and one lock-washer.

Vacuum cast in polyurethane resin.

Other ratios, secondary currents and dual ratios are available. Refer to factory.

The transformers are tested for partial discharge to Canadian Standards CAN3-C13-M83. This test can also be carried out to IEC requirements if requested.

Approximate weight

41 lbs.

Regulatory Agencies



BAR SIZES

| PRIMARY CURRENT | DIMENSIONS | |
|-----------------|------------|------|
| | A | B |
| 5 TO 250A | 0.25 | 1.50 |
| 300 TO 1200A | 0.38 | 2.00 |



Another HUNTINGTON ELECTRIC Company

CR Magnetics, Inc. 3500 Scarlet Oak Blvd. St. Louis MO USA 63122 V: 636-343-8518 F: 636-343-5119

Web: <http://www.crmagnetics.com>

E-mail: sales@crmagnetics.com

CTWH3-60-T100 RECOMMENDED MINIMUM SPACINGS

- A; Unit to Unit
= 0.75" minimum.
- B; HV to Ground in Air
= 3.00" minimum.

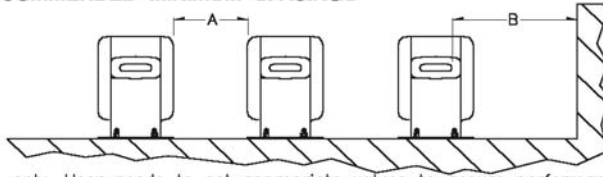

Recommended spacings are for guidance only. User needs to set appropriate values to assure performance for high potential test, impulse test, high humidity, partial discharge, high altitude, and other considerations like configuration.

